

# Corner Record

Document Number 2539

City of \_\_\_\_\_

County of Sacramento, California

### Brief Legal Description

The centerline intersection of Eastern Avenue and Rand Avenue, as shown on the "Plat of Mariemont No. 3", filed in the Office of the Recorder of the County of Sacramento in Book 30 of Maps, at Page 12.

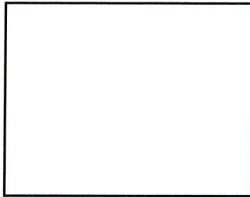

### Corner Type

### Coordinates

(Optional)

Government Corner ( )	Control ( )	N. _____
Meander ( )	Property (x)	E. _____
Rancho ( )	Other ( )	Zone _____ Datum _____
Date of Survey <u>3/18/2009</u>		Elev. _____

Corner- Left as Found ( ) Found and Tagged ( ) Established ( ) Reestablished (x) Rebuilt ( )

### Identification and Type of Corner Found, Evidence used to Identify or Procedure used to Establish or Reestablish the corner:

Found nail and washer monument at the centerline intersection of Eastern Avenue and Rand Avenue, the "Plat of Mariemont No. 3" calls for a dimension point at this location. Set 3/4" Sacramento County brass tags in concrete for reference points. Refer to Sacramento County field notes E-233, page RP-4, 3/18/2009.

### A Description of the Physical Condition of the Monument as Found and as Set or Reset:

Replaced original monument on 10/8/2010 with 2 1/2" brass disc, stamped "Sacramento Co. Municipal Services, 2010", in monument well after original monument was destroyed as a result of construction.

### Surveyor's Statement

This Corner Record was prepared by me or under my direction in conformance with the Land Surveyor's Act on 4/5/2011



Signed [Signature]  
Larry S. Savio

LS # 7965

### County Surveyor's Statement

This Corner Record was received 4/11, 2011 and examined and filed 4/12, 2011

Signed [Signature]  
William M Carmack - LS #5887

Title: Principal Land Surveyor



County Surveyor's Comments:

AC OVERLAY PROJECT

Crew: DOUG BEAN Date: 3-18-09

Project: EASTERN AVE. - F.O.B. to ARDEN way

SHAWN MURRAY Page: RP-4

△ = SET 2 1/2" BRASS DISK IN MONUMENT  
 WELL STAMPED "SACRAMENTO CO.  
 MUNICIPAL SERVICES 2010" PUNCHED  
 ON 10/18/2010

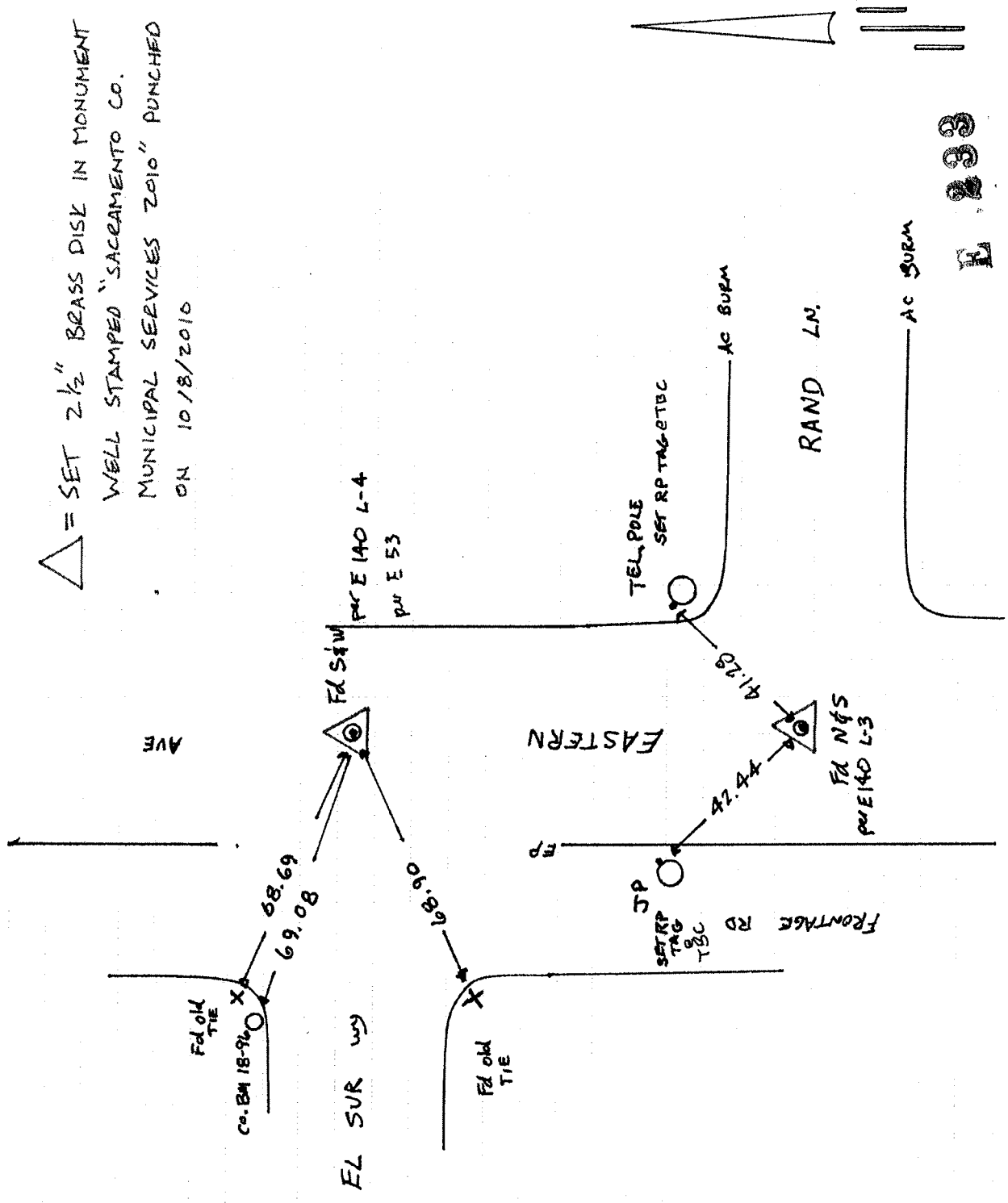

E 233