

# Corner Record

Document Number 2529

City of \_\_\_\_\_

County of Sacramento, California

## Brief Legal Description

The centerline intersection of Winding Way and Minnesota Ave, as shown on the Record of Survey map titled "Portions lots 1 &2, Block 1, Plat No.1 Fair Oak Addition" filed in the Office of the Recorder of the County of Sacramento in Book 41 of Surveys, at Page 35.

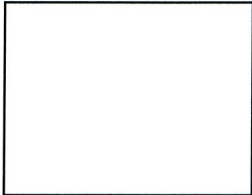

## Corner Type

## Coordinates

(Optional)

Government Corner ( )	Control ( )	N. _____
Meander ( )	Property (x)	E. _____
Rancho ( )	Other ( )	Zone _____ Datum _____
Date of Survey <u>3/20/2009</u>		Elev. _____

Corner- Left as Found ( ) Found and Tagged ( ) Established ( ) Reestablished (x) Rebuilt ( )

## Identification and Type of Corner Found, Evidence used to Identify or Procedure used to Establish or Reestablish the corner:

Found 3/8" iron pin at the centerline intersection of Winding Way and Minnesota Ave, per the Record of Survey map titled "Portions lots 1 &2, Block 1, Plat No.1 Fair Oak Addition". Set 3/4" Sacramento County brass tags in concrete for reference points. Refer to Sacramento County field notes W226, page RP-4, 3/20/2009.

## A Description of the Physical Condition of the Monument as Found and as Set or Reset:

Replaced original monument on 10/8/2010 with 2 1/2" brass disc, stamped "Sacramento Co. Municipal Services, 2010", in monument well after original monument was destroyed as a result of construction.

## Surveyor's Statement

This Corner Record was prepared by me or under my direction in conformance with the Land Surveyor's Act on 4/1/2011

Signed Larry S. Savio  
Larry S. Savio

LS # 7965



## County Surveyor's Statement

This Corner Record was received 4/11, 2011 and examined and filed 4/12, 2011

Signed William M Carmack  
William M Carmack - LS #5887

Title: Principal Land Surveyor

County Surveyor's Comments:



AC OVERLAY PROJECT

Crew: DOUG DEAN

Date:

Project: WINDING way - SAN JUAN to SUNRISE ave

SHAWN MURRAY

Page: RP - 4

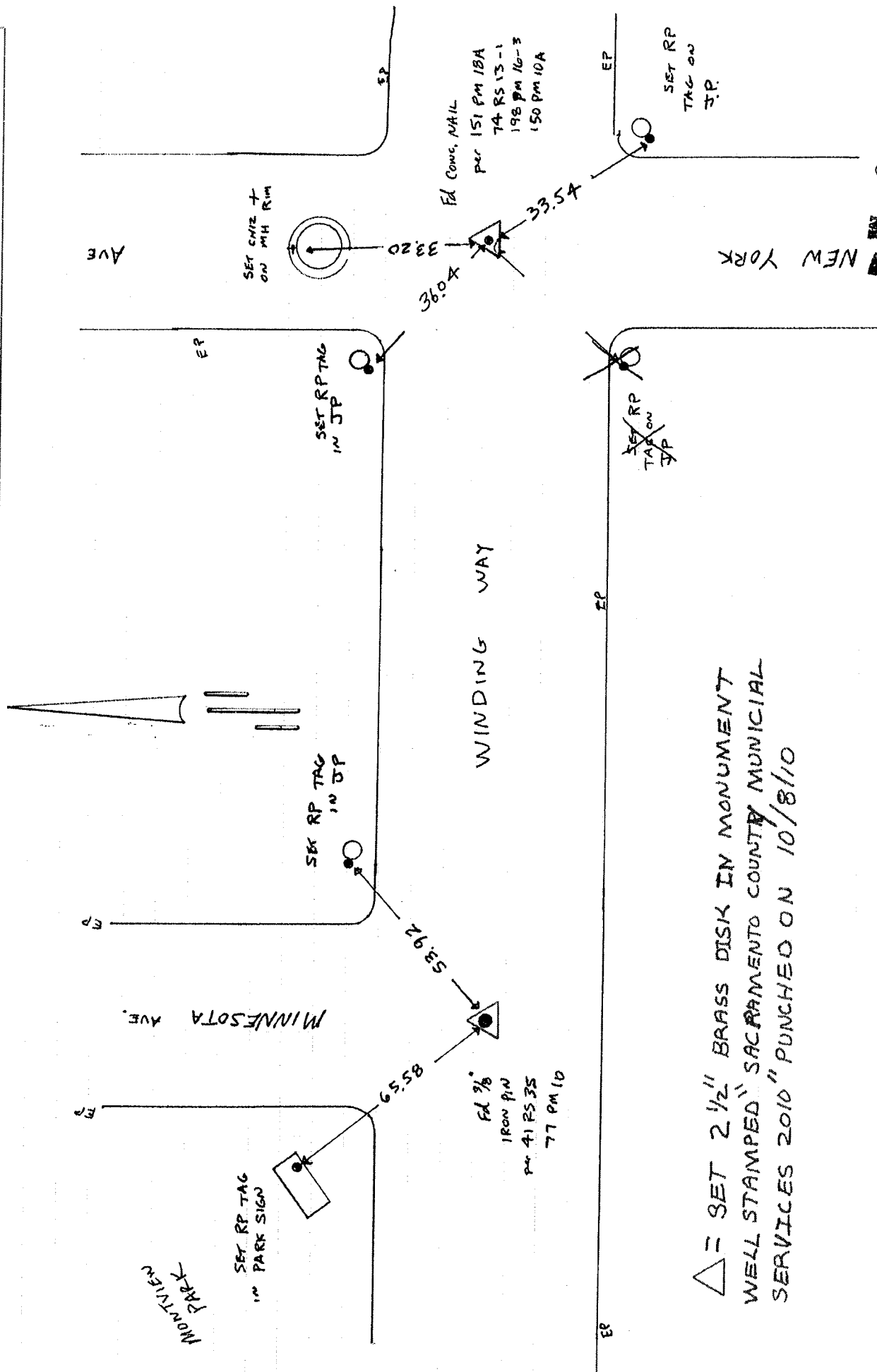

△ = SET 2 1/2" BRASS DISK IN MONUMENT WELL STAMPED "SACRAMENTO COUNTY MUNICIPAL SERVICES 2010" PUNCHED ON 10/8/10