

# CORNER RECORD

Document Number 2459

City of ELK GROVE

County of SACRAMENTO, California

Brief Legal Description \_\_\_\_\_

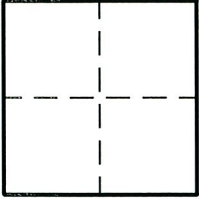

### CORNER TYPE

Government Corner  Control   
 Meander  Property   
 Rancho  Other   
 Date of Survey July 12, 2010

### CORNER TYPE (Optional)

N. \_\_\_\_\_  
 E. \_\_\_\_\_  
 Zone \_\_\_\_\_ Datum \_\_\_\_\_  
 Elev. \_\_\_\_\_

**Corner** - Left as found  Found and tagged  Established  Reestablished  Rebuilt

Identification and type of corner found: Evidence used to identify or procedure used to establish or reestablish the corner.

ALL FOUND MONUMENTS ARE OF THE CHARACTER DESCRIBED AS FOLLOWS:

FOUND 3/4" IRON PIPE IN CENTERLINE OF ADOBE VALLEY COURT PER 141 RM 18, S.C.R.

A description of the physical condition of the monument as found and as set or reset. \_\_\_\_\_

### SURVEYOR'S STATEMENT

This Corner Record was prepared by me or under my direction in conformance with the Land Surveyor's Act on July 15, 2010.

Signed Scott A. Bryant (L.S.) or R.C.E. Number 7228.

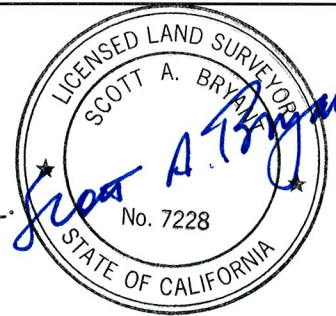

### COUNTY SURVEYOR'S STATEMENT

This Corner Record was received 12/28 2010.

and filed 1/7 2011.

Signed Larry S. Savio Title ASSOC. L.S.



County Surveyor's Comment \_\_\_\_\_

# LEGEND

Document Number \_\_\_\_\_

x SET LEAD & TAG STAMPED PLS 7228 AT BACK OF WALK

o FOUND 3/4" IRON PIPE, PER 141 RM 18, S.C.R.

8966 STREET ADDRESS



NOT TO SCALE

