

# CORNER RECORD

Document Number 2409  
City of ELK GROVE County of SACRAMENTO, California

Brief Legal Description \_\_\_\_\_

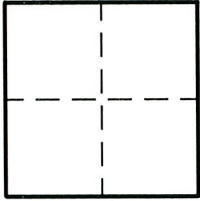

### CORNER TYPE

Government Corner  Control   
Meander  Property   
Rancho  Other   
Date of Survey October 14, 2010

### CORNER TYPE (Optional)

N. \_\_\_\_\_  
E. \_\_\_\_\_  
Zone \_\_\_\_\_ Datum \_\_\_\_\_  
Elev. \_\_\_\_\_

Corner - Left as found  Found and tagged  Established  Reestablished  Rebuilt

Identification and type of corner found: Evidence used to identify or procedure used to establish or reestablish the corner.  
FOUND 3/4" IRON PIPE IN CENTERLINE OF HARBOUR POINT DRIVE PER 164 PM 9, S.C.R.; TIED AS SHOWN WITH LEAD & BRASS TAG STAMPED PLS 7228. AFTER CONSTRUCTION RESET FROM TIES WITH 3/4" IRON PIPE & CAP STAMPED PSOMAS PLS 7228 IN CENTERLINE OF HARBOUR POINT DRIVE.

A description of the physical condition of the monument as found and as set or reset. \_\_\_\_\_  
\_\_\_\_\_  
\_\_\_\_\_

### SURVEYOR'S STATEMENT

This Corner Record was prepared by me or under my direction in conformance with the Land Surveyor's Act on November 1, 2010.

Signed Scott A. Bryant L.S. or R.C.E. Number 7228

### COUNTY SURVEYOR'S STATEMENT

This Corner Record was received 12/28 2010.

and filed 1/3 2011.

Signed Larry S. Savio Title ASSOC. L.S.

County Surveyor's Comment \_\_\_\_\_  
\_\_\_\_\_  
\_\_\_\_\_

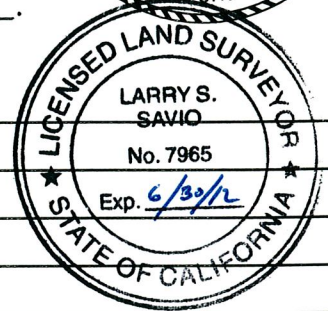

# LEGEND

Document Number \_\_\_\_\_

- × SET LEAD & TAG STAMPED PLS 7228 AT BACK OF WALK
- SET 3/4" IRON PIPE & CAP STAMPED PSOMAS PLS 7228
- 9561 STREET ADDRESS



NOT TO SCALE

