

CORNER RECORD

233

COUNTY OF Sacramento T. 10 N R. 6 E MDM MERIDIAN CALIFORNIA

CORNER TYPE: GOV'T. CORNER MEANDER RANCHO CONTROL OTHER

CORNER IDENTIFICATION — DATE OF VISIT _____ 19____

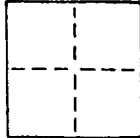

26 PM 48

CORNER — LEFT AS FOUND FOUND AND TAGGED REESTABLISHED OBLITERATED CORNER REBUILT

PHYSICAL DESCRIPTION OF CORNER FOUND; EVIDENCE AND METHOD USED TO IDENTIFY OR REESTABLISH

PHYSICAL DESCRIPTION OF MONUMENTS REBUILT OR PERPETUATED

CALIFORNIA COORDINATE SYSTEM ORDER: FIRST SECOND THIRD
STATIONS USED: NGS (USC & GS) STATE COUNTY OTHER STATION _____ STATION _____
ZONE _____ ELEVATION _____ NORTHINGS (Y) _____ EASTINGS (X) _____

SKETCH: (Include reference tie or witness points, remarks and topo of area)

Reset northeast corner of Parcel Map 26-48
5/8" rebar with cap stamped L.S. 5030
see attached map

SURVEYOR'S CERTIFICATE
THIS CORNER RECORD WAS PREPARED BY ME UNDER MY DIRECTION IN CONFORMANCE WITH THE LAND SURVEYORS ACT ON MAY 20
SIGNED: Richard A. Varney Exp. 12-31-89
L.S. or R.C.E. No.: LS 5030

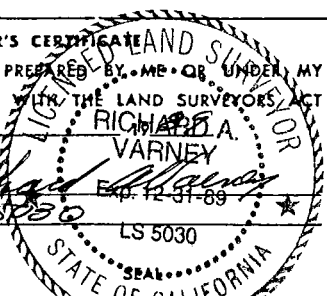

COUNTY SURVEYOR'S CERTIFICATE
THE CORNER RECORD WAS RECEIVED MAY 24 1989
AND EXAMINED AND FILED MAY 24 1989
BY [Signature]
TITLE: Supervising Engineering Tech
DOCUMENT No. 233

STATEMENT ON BACK OF SHEET YES NO

PLAT OF PARCEL A

RESET NE CORNER PARCEL A, R/W 26 PM 48

PORTION OF SW 1/4 S 18, TION, R6E, MDM
SACRAMENTO COUNTY

MAY 1989

SCALE 1" = 100'

VARNEY LAND SURVEYS

SURVEYORS STATEMENT

THIS IS A TRUE REPRESENTATION OF A SURVEY DONE BY ME IN NOVEMBER OF 1988, AT THE REQUEST OF THE SACRAMENTO HOUSING AND REDEVELOPMENT AGENCY.

Richard A. Varney
RICHARD A. VARNEY
L.S. 5030

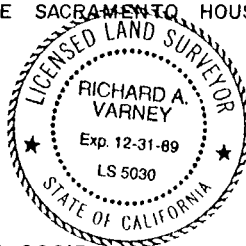

LEGEND

- o DIMENSION POINT
- oox FD. 5/8" REBAR WITH TAG R.C.E. 20213
- oox SET 5/8" REBAR WITH CAP STAMPED L.S. 5030

BASIS OF BEARINGS

THE BEARINGS OF THIS SURVEY ARE THE SAME AS THOSE BEARINGS AS SHOWN ON
26 PM 48

