

CORNER RECORD

Document Number 2299

City of ELK GROVE

County of SACRAMENTO, California

Brief Legal Description BEING A PORTION OF "SLEEPY HOLLOW ESTATES" 215 R.M. 21, A.P. MAP: BK. 122 PG. 26

N	1/2
SEC	
2	2

CORNER TYPE

Government Corner Control
 Meander Property
 Rancho Other

Date of Survey 8-7-09

COORDINATES(Optional)

N. _____
 E. _____
 Zone _____ NAD27 NAD83
 NAD83 Epoch _____
 Elevation _____
 Vert. Datum: NGVD29 NAV88
 Meas. Units: Metric Imperial

T. 7 N., R. 6 E. M.D.M.

Corner - Left as found Found and tagged Established Reestablished Rebuilt

Identification and type of corner found: Evidence used to identify or procedure used to establish or reestablish the corner:

FOUND 3/4" CAPPED IRON PIPE, NUMBERS ILLEGIBLE, LOCATED AT NORTH END OF MECCA ROAD ADJACENT TO CENTER OF CUL-DE-SAC AS SHOWN ON SAID MAP.

A description of the physical condition of the monument as found and as set or reset: RE-TAGGED FOUND 3/4" IRON PIPE WITH PLASTIC CAP STAMPED L.S. 4154.

SURVEYOR'S STATEMENT

This Corner Record was prepared by me or under my direction in conformance with

the Land Surveyor's Act on 11-07, 2009.

Signed Terry L. Castle P.L.S. or R.C.E. Number L.S. 4154



COUNTY SURVEYOR'S STATEMENT

This Corner Record was received 5/5, 2010 and examined

and filed 5/7, 2010.

Signed Larry S. Savio P.L.S. or R.C.E. Number 7965

Title ASSOC. L.S.

County Surveyor's Comment _____

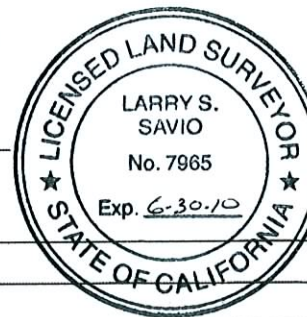

SCALE: 1" = 20'

LOT 1

RP #2
SET 1/2" REBAR
W/ CONTROL CAP
& ATTACHED METAL DISC
STAMPED LS 4154

3/4" IRON PIPE
TAGGED WITH PLASTIC CAP
STAMPED L.S. 4154
NORTH END MECCA ROAD

CENTER 54' RADIUS
CUL-DE-SAC

N60°39'15"W 68.47

S88°17'32"W 24.00'

Δ = 180°00'06"

66.95

S29°22'05"W

RP #3
SET 1/2" REBAR
W/ CONTROL CAP
& ATTACHED METAL DISC
STAMPED LS 4154

C/L
MECCA ROAD
N01°42'28"W 395.48'

Δ = 90°01'26"

S60°39'21"E 21.19'

RP #1
SET 1/2" REBAR
W/ CONTROL CAP
& ATTACHED METAL DISC
STAMPED LS 4154

N01°42'28"W 890.00'

LOT 12

"SLEEPY HOLLOW ESTATES"
215 R.M. 21

MONUMENT TIE EXHIBIT

C/L MECCA ROAD AT
NORTH END NEAR CUL-DE-SAC, 215 R.M. 21
CITY OF ELK GROVE
SACRAMENTO COUNTY, CALIFORNIA



CLAYBAR ENGINEERING, INC.

9354 ELK GROVE-FLOLIN ROAD
ELK GROVE, CA 95624
Ph.: 916-684-7301
Fax: 916-684-2627
(P.T. NO. 1053)