

Corner Record

Document Number 1859

City of _____

County of Sacramento, California

Brief Legal Description

The intersection of the construction centerline of Watt Ave. and the centerline of Greenview Lane as shown on Sacramento County Survey Field Notes Vol. W-197, page L-11, dated 08/25/2003 and Vol. W-33, page L-16 (Garrison).

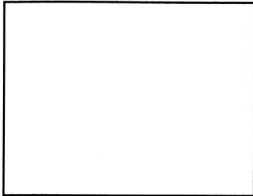

Corner Type

Coordinates

(Optional)

Government Corner	()	Control	()	N.	_____
Meander	()	Property	(x)	E.	_____
Rancho	()	Other	()	Zone	_____ Datum
Date of Survey	<u>3/07/2007</u>	Elev.	_____		

Corner- Left as Found () Found and Tagged () Established () Reestablished (x) Rebuilt ()

Identification and Type of Corner Found, Evidence used to Identify or Procedure used to Establish or Reestablish the corner:

Found spike and washer monument at the intersection of the construction centerline of Watt Ave. and the centerline of Greenview Lane as shown on Sacramento County Survey Field Notes Vol. W-197, page L-11, dated 08/25/2003 and Vol. W-33, page L-16 (Garrison). Set 3/4" Sacramento County brass tags in concrete for reference points. Refer to Sacramento County field notes W-220, page RP-05, 3/06/2007.

A Description of the Physical Condition of the Monument as Found and as Set or Reset:

Replaced original monument on 1/07/2008 with Type "A" monument with a 2 1/2" brass "Sacramento Co. Municipal Services, 2007" in original position after original monument was destroyed as a result of construction.

Surveyor's Statement

This Corner Record was prepared by me or under my direction in conformance with The Land Surveyor's Act on 02/06/08

Signed Thomas F. X. Sekel
Thomas F. X. Sekel

L.S. 4897



County Surveyor's Statement

This Corner Record was received 2/19, 2008 and examined and filed 2/21, 2008

Signed Larry Savio
Larry Savio

Title : Associate Land Surveyor

County Surveyor's Comments:



Project: WATT AVE BEAUTIFICATION PHASE II

Crew: KLIPSECH MURRAY

Date: 03/07/07
Page: R P 5 OF 13

8+17.12 SPIKE END @ GREENVIEW LN & WATT AVE
Per ~~letter~~ 0197 L-11 OF 18
3 W33 PG L-16, GARRISON

SET TYPE "A" MON WITH 2 1/2" BEARS
DISC STAMPED "SACRAMENTO CO.
MUNICIPAL SERVICES 2007" 11/07/08

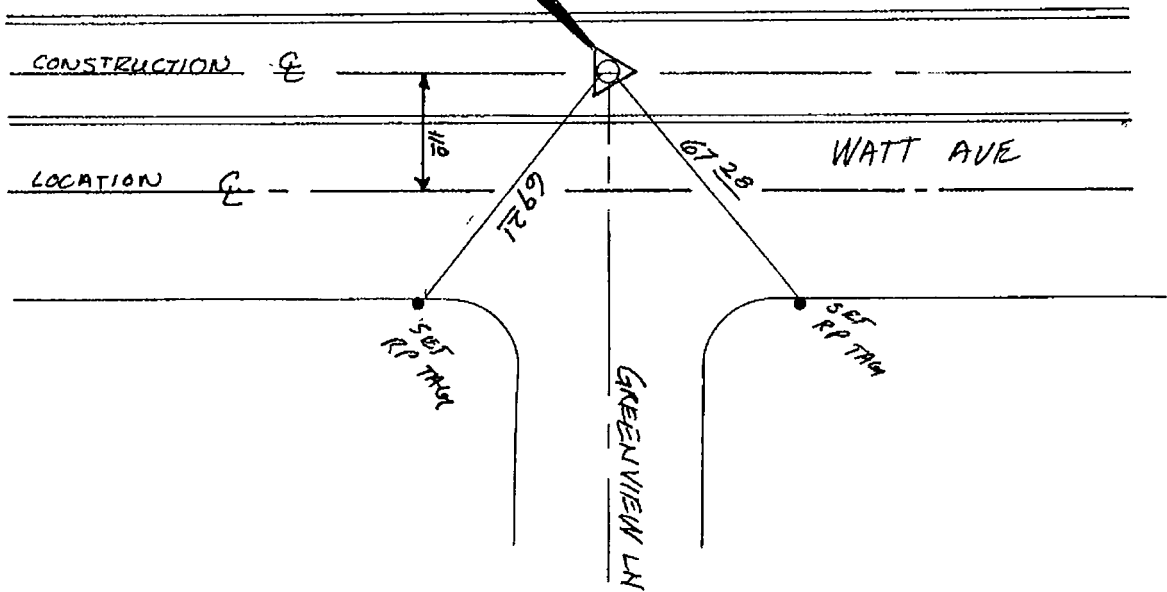
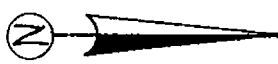

SEE W-33 PG L-16
L-14 TRUL L-18 FOR
LOCATION & 3/4
CONSTRUCTION &
RELATIONSHIP

*

*