

Corner Record

Document Number 1669

City of _____

County of Sacramento, California

Brief Legal Description

The beginning of a 1500' radius curve on Roseville Road at station 152+62.75 as shown on Sacramento County Field Notes Vol. R-25, Page L-3A.

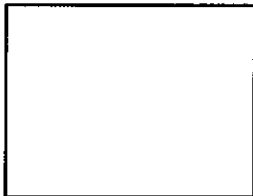

Corner Type

Coordinates

(Optional)

Government Corner <input type="checkbox"/>	Control <input type="checkbox"/>	N. _____
Meander <input type="checkbox"/>	Property <input checked="" type="checkbox"/>	E. _____
Rancho <input type="checkbox"/>	Other <input type="checkbox"/>	Zone _____ Datum _____
Date of Survey <u>8/14/2005</u>	Elev. _____	

Corner- Left as Found Found and Tagged Established Reestablished Rebuilt

Identification and Type of Corner Found, Evidence used to Identify or Procedure used to Establish or Reestablish the corner:

Found 3/4" iron pipe monument at the beginning of a 1500' radius curve on Roseville Road at station 152+62.75 as shown on Sacramento County Field Notes Vol. R-25, Page L-3A. Set 3/4" Sacramento County brass tags in concrete for reference points. Refer to Sacramento County field notes R-108, page RP-3, 8/14/2005.

A Description of the Physical Condition of the Monument as Found and as Set or Reset:

Replaced original monument on 5/16/2007 with 2 1/2" brass disc in monument well stamped "Sacramento Co. Municipal Services, 2006" in original position after original monument was destroyed as a result of construction.

Surveyor's Statement

This Corner Record was prepared by me or under my direction in conformance with The Land Surveyor's Act on 5/29/2007

Signed Thomas F. X. Sekel
Thomas F. X. Sekel

L.S. or R.C.E. LS 4897



County Surveyor's Statement

This Corner Record was received 9/28, 2007 and examined and filed 10/1, 2007

Signed Larry Savio
Larry Savio

Title: Associate Land Surveyor

County Surveyor's Comments:



ROSEVILLE RD - OAK HOLLOW DR TO GOLD RUN AVE
 AL. OUBRY TEA 3 PH 1
 RYAN L MING 8-14-05
 SHAWN MURRAY RR-3 03

ANTONIO BARBALES

- 160+74⁰² FND 3/4" I.P. @ INTX ROSEVILLE RD & GOLD RUN AVE PER 119 PM 1, R-103 R.P. 1
- 158+77¹⁷ E.C. NOTHING SET NOTHING FOUND
- 152+62⁷⁵ A H BC
- 152+62⁷⁵ BK FND 3/4" I.P. @ BC. PER R-25 L-3A
- 151+23⁶¹ E.C. FND 3/4" I.P. @ E.C. PER R-25 L-3A
- 142+73³⁹ BC FND 3/4" I.P. @ BC & PER R-25 L-3 A
- 124+71³⁵ FND SAC. CO. S/W @ INTX ANDREA & ROSEVILLE RD PER R-25 L-2B

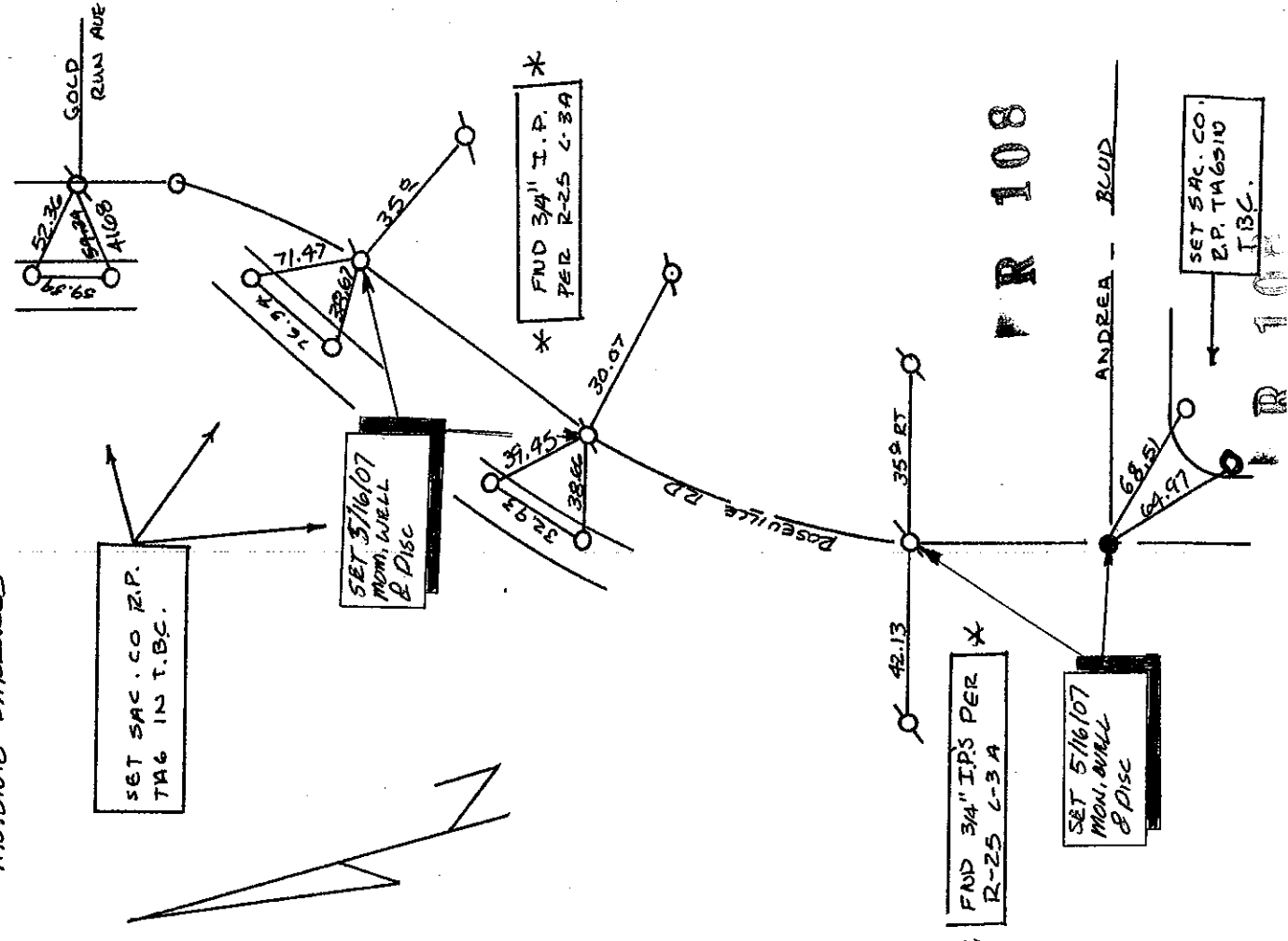

R 108

R 108