

CORNER RECORD

COUNTY OF Sacramento, CA

City of Sacramento

Document Number 1539

Brief Legal Description Parcel 19, Book 1 Page 17 of Parcel Maps

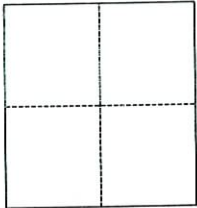

SEC 14
T8N
R5E

CORNER TYPE

Government Corner Control
 Meander Property
 Rancho Other
 Date of Survey May 24, 2006

COORDINATES (Optional)

N. _____
 E. _____
 Zone _____ Datum _____
 Elev. _____

Corner — Left as Found Found and tagged Established Reestablished Rebuilt

Identification and type of corner found: Evidence used to identify or procedure used to establish or reestablish the corner:

Set front and rear lot corner based on found monuments

A description of the physical condition of the monument as found and as set or reset: _____

Set 5/8" rebar with brass tag stamped LS 5303 at rear and set mag nail & washer stamped LS 5303 at front

SURVEYOR'S STATEMENT

This Corner Record was prepared by me or under my direction in conformance
 with the Land Surveyors' Act on May 24 20 06.
 Signed Gary Leonard L.S. or R.C.E. Number 5303

COUNTY SURVEYOR'S STATEMENT

This Corner Record was received 12/29 20 06 and examined
 and filed 12/29 20 06
 Signed Larry Savio Title Assoc. C.S.

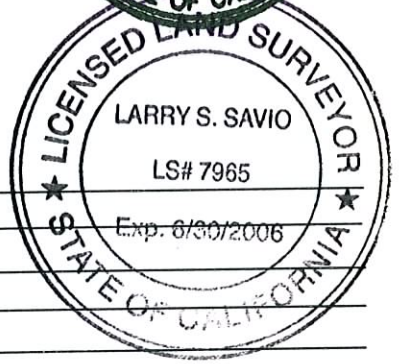

County Surveyor's Comment _____

BOOK _____
CORNER RECORDS PAGE _____

