

CORNER RECORD

COUNTY OF SACRAMENTO T. _____ R. _____ MERIDIAN _____ CALIFORNIA
 CORNER TYPE: GOVT. CORNER MEANDER RANCHO CONTROL OTHER
 CORNER IDENTIFICATION — DATE OF VISIT SEPTEMBER 19 85

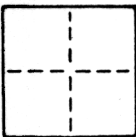

ALL CORNERS OF LOT 17,
 WEYAND LIGHT INDUSTRIAL TRACT
 BOOK 62 OF MAPS, MAP NO. 22

CORNER — LEFT AS FOUND FOUND AND TAGGED REESTABLISHED OBLITERATED CORNER REBUILT

PHYSICAL DESCRIPTION OF CORNER FOUND; EVIDENCE AND METHOD USED TO IDENTIFY OR REESTABLISH

CORNERS REESTABLISHED PER PLAT OF
 WEYAND LIGHT INDUSTRIAL TRACT

PHYSICAL DESCRIPTION OF MONUMENTS REBUILT OR PERPETUATED

SEE SKETCH

CALIFORNIA COORDINATE SYSTEM ORDER: FIRST SECOND THIRD
 STATIONS USED: NGS (USC & GS) STATE COUNTY OTHER STATION _____ STATION _____
 ZONE _____ ELEVATION _____ NORTHINGS (Y) _____ EASTINGS (X) _____

SKETCH: (Include reference tie or witness points, remarks and topo of area)

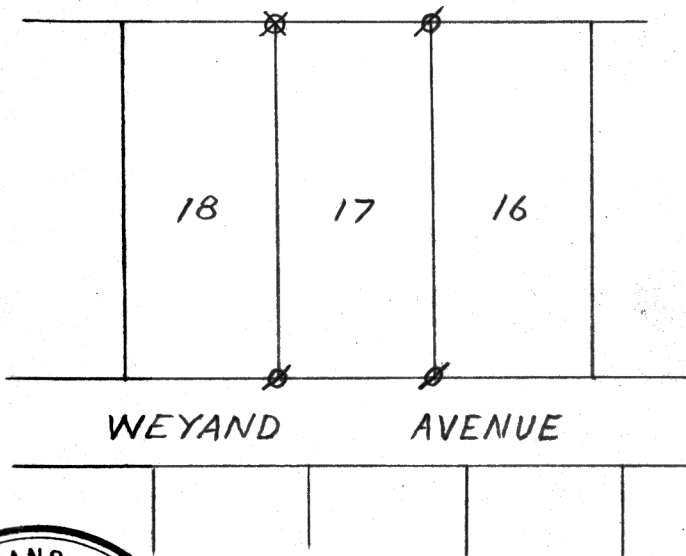

Ø SET 1/4" O.D. IRON PIPE TAGGED L.S. 2457
 X FOUND 3/4" REBAR TAGGED L.S. 4732
 ADDED TAG L.S. 2457

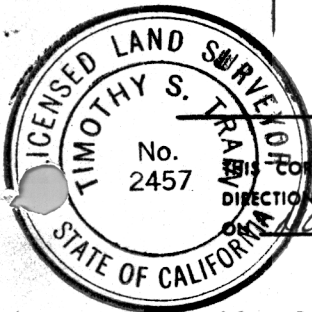

SURVEYOR'S CERTIFICATE
 THIS CORNER RECORD WAS PREPARED BY ME OR UNDER MY
 DIRECTION IN CONFORMANCE WITH THE LAND SURVEYORS ACT
 OF NOVEMBER 21 1986
 SIGNED: Timothy S. Trautman
 L.S. or R.C.E. No.: LS 2457

COUNTY SURVEYOR'S CERTIFICATE
 THE CORNER RECORD WAS RECEIVED NOV 25 1986
 AND EXAMINED AND FILED DEC 19 1986
 BY: D. PARKER
 TITLE: SUPERVISING ENG TECH
 DOCUMENT No. 104

STATEMENT ON BACK OF SHEET

YES NO

SEAL